

5. Charging

Charge the device with a type-C charging cable, the flash icon on the display will keep flashing during the charging process and go off when the charging is done.

WARNING

- Always keep the device away from children;
- Don't open the vaping device and don't attempt to repair the device yourself. Disassembling the device may damage it or may cause injury to you;
- Do not cover the Device with items such as newspapers, tablecloths, or curtains, and do not use this Device on soft support such as bedding, blankets, etc. It may cause burns and other injuries if the battery leaks or overheats during the night;
- Do not use your Device near sinks or other wet locations;
- Do not expose this Device to rain or moisture;
- Do not expose your device to extreme heat or cold. This may result in a risk of battery damage, other injury, or property damage;
- Do not leave the vaping device in direct sunlight or near heat sources;
- Do not use the vaping device near flammable liquids or gases.
- Please disconnect the pod and the device when you take it by airplane.

DISPOSAL

- Dispose of the packaging and the device shall always be in accordance with national and local laws and regulations.
- Never put the vaping device on fire. The built-in lithium-ion battery may burst or explode.



www.firerose-tech.com



FIREROSE CLICK

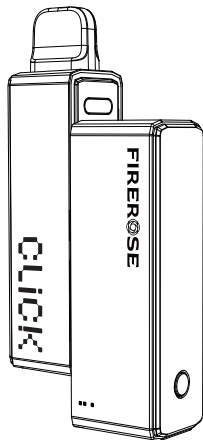

User Manual

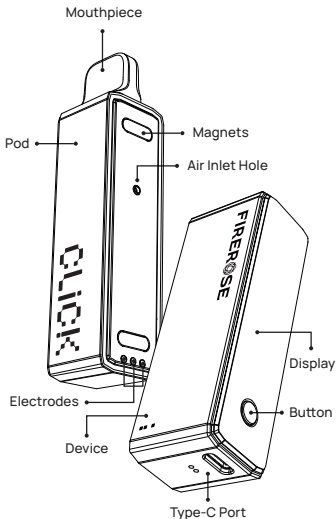

PARAMETERS:

Size: 97.8*49.7*23.3mm

Puffs: Up to 18000 puffs

Battery Capacity: 2200mAh (Device)+200mAh (Pod)

Coil: Dual Mesh Coil

Charging Port: Type-C

INSTRUCTIONS

1. Vape

- Remove the insulation film at the bottom of the product.
- Press the button 3 times to lock/unlock the device. When it is locked, the vaping function is disabled and the display only shows the locked icon.

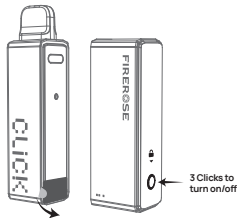

- Draw to vape. The pod can be used with or without the device. When used without device, it is in soft mode and when used with device, it is in boost mode.

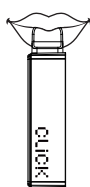

Soft Mode

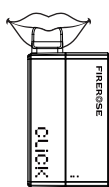

Boost Mode

2. Digital Display

- Pod E-liquid: Displays the current capacity of the pod.
- Cube: Flashes during vaping.
- Power Supplying Hint: Appears when the product provides power to other devices.
- Battery Level: Displays the current battery capacity.
- Lock Icon: Appears when the device is locked. The display will go off after 15 seconds of inactivity, and can be lightened up by one button click or vaping.

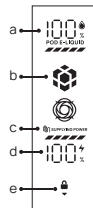

3. Power Supply

The device can be used as a portable power source. Connect other electronic devices to the Type-C port with a charging cable, then press the button once to start charging. During charging, the display will enter standby mode in 10 seconds and the Power Supplying Hint will stay on during the charging process.

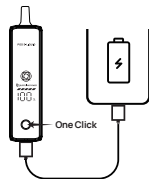

4. App Control

Scan the QR code to download app. Open the app on your phone and connect it with your device to manage your device and record your vaping habits.



Android



iOS